



Low battery
indicator inside



Security Wall light



Luxform Global BV Transportstraat 1 8263 BW Kampen The Netherlands

LED Motion Activated Battery Operated Security Light

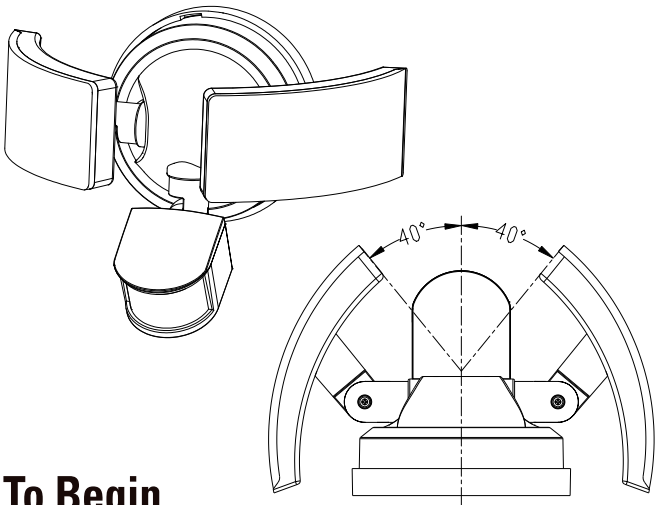

To Begin

WARNING: Review important safety instructions before installation. Check to make sure you have the following:

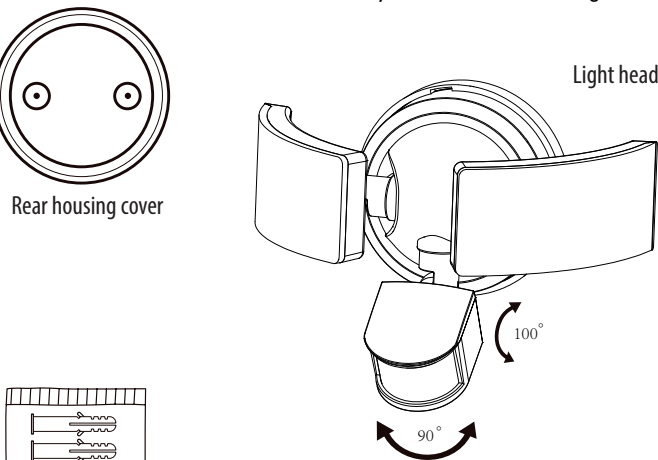

Screws and plugs are INCLUDED

Hardware Kit (Actual hardware may differ from illustration)

Items Required

Installation Time: 45 Minutes.

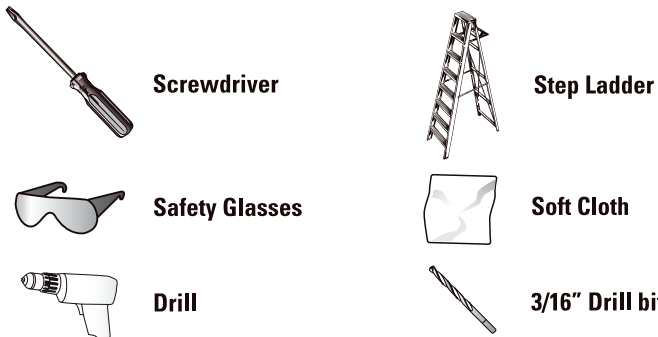

Preparation

WARNING: LEDs can be damaged by electro static discharge (ESD) shock. Before installation, discharge yourself by touching a grounded bare metal surface to remove this hazard. To avoid damage, do not remove the clear lens over the LED module.

IMPORTANT SAFETY INSTRUCTIONS

1. Do NOT touch LEDs.
2. Do NOT remove the protective clear LED lens.
3. Do NOT look directly at lighted LEDs for any length of time.
4. Electrical requirements: 4.5V DC.
5. Fixture can only be wall mounted. NOT suitable for ground mount or eave mount installations.

Select the installation location carefully. Do not install in areas having pedestrian or motorized traffic, pools or bodies of water, or trees/bushes that move in the wind. All of these may trigger the motion sensor security light and may be disruptive to the intended operation of the light.

Fixture Installation

1. Remove the rear housing cover by turning counter-clockwise until it comes loose (Fig. 1).
2. For mounting to concrete or masonry, install the anchors, by drilling two 3/16-in. pilot holes into the mounting surface. Insert the anchors into the holes and tap them into place so they are flush with the surface (Fig. 2). Place the rear housing cover, with the writing facing away from the wall, over the mounting location and secure the rear housing cover to the mounting surface with wood screws (Fig. 3).
3. Remove the screw on the battery compartment cover (Fig. 4). With your fingertip, pull up on the battery compartment catch and pull outward to remove the battery compartment cover (Fig. 5).
4. Insert 3 alkaline C cell batteries (included) into the battery compartment and orient them with the "+" and "-" markings on the back of the battery compartment (Fig. 6). Re-attach the battery compartment cover by aligning the legs on the lower edge of the battery compartment cover onto the fixture body and close the cover until the catch at the top engages. Replace the screw. Do not mix old and new batteries. Cold weather may have a negative impact on battery life.
5. Move the switch to ON.
6. Attach the security light to the rear housing cover by positioning the security light over the rear housing cover at an angle. Engage the security light into the grooves of the rear housing cover and secure by twisting clockwise until the security light is seated vertically (Fig. 7).

Operating Instructions

1. The individual light heads can be adjusted side to side and up/down independently to aim the light heads in the direction desired (Fig. 1).
2. The motion sensor can be rotated to position in the direction of an area to be covered. The motion sensor can be rotated approximately 50 degrees right or left of center (Fig. 2). The motion sensor has a maximum detection field of 120° at a distance of 30 ft.
3. The control knobs for adjusting the operation of the security light (TIME, SENS and LUX) are located on the bottom side of the motion sensor. (Fig. 3).
4. The TIME control knob can be adjusted to control the length of time the light stays ON when triggered by the PIR sensor (Fig. 4). In the far left position (-), the duration time is approximately 10 seconds. In the far right position (+) the duration time is approximately 30 seconds.
5. The SENS control knob can be adjusted to control the range of the PIR sensor (Fig. 5). The far left position (-) sets the PIR sensor range to approximately 1 foot. The far right (+) sets the PIR range to approximately 30 feet.
6. The LUX control knob can be adjusted for the surrounding level of darkness needed to activate the PIR (Fig. 6). This is quite variable. The far left position (-) sets for minimum level of darkness. The far right position (+) sets for a maximum level of darkness (or near full darkness).

Battery Replacement

When the red LED low battery indicator inside the PIR (see front page for situation) is on permanently, the batteries are running low (5%) and need to be replaced. Alkaline batteries can last up to 300 days if the security light is activated for 20 seconds at 4 times per night.

1. Remove the security light from the rear housing cover by gripping the fixture and turning counter clockwise until the catches disengage from the rear housing cover (Fig. 1).
2. Remove the screw on the battery compartment cover (Fig. 2). With your fingertip, pull up on the battery compartment catch and pull outward to remove the battery compartment cover (Fig. 3). Remove the old batteries and discard.
3. Insert 3 new alkaline C cell batteries into the battery compartment according to the "+" and "-" markings near the battery drawings (Fig. 4). Re-attach the battery compartment cover by aligning the legs on the lower edge of the battery compartment cover onto the fixture body and close the cover until the catch at the top engages. Replace the screw. Do not mix old and new batteries. Cold weather may have a negative impact on battery life.
4. Re-attach the security light to the rear housing cover by positioning the security light over the rear housing cover at an angle; engaging the security light into the grooves of the rear housing cover until the security light is seated vertically (Fig. 5).

Care and Maintenance

IMPORTANT: Periodically clean the fixture and diffuser using a mild, non-abrasive cleaner and soft cloth. When cleaning the fixture, make sure the power is turned off. Do not spray cleaner directly onto any part of the fixture or LEDs.

IMPORTANT: This fixture uses LEDs (light emitting diodes) to provide light. LEDs do not burn out like traditional light bulbs and will last for 30 years or more (based on 3 hours of usage per day).

Troubleshooting Guide

Extreme hot or cold weather could affect the performance of the built-in sensors that detect body heat. Certain winter clothing can shield a person's body heat from the sensor during extreme cold weather. During extreme hot weather, the sensor may not be able to distinguish the difference between normal body temperatures and the surrounding high temperatures. The sensor will begin working normally once weather conditions return to normal.

Problem	Cause	Solution
Fixture does not light.	1. ON/OFF switch is not set correctly.	1. Slide ON/OFF switch to ON position.
	2. Batteries are defective.	2. Replace the batteries.
	3. Batteries are installed wrong.	3. Install the batteries correctly.
	4. Battery compartment cover is loose.	4. Check battery compartment cover and/or screw.
Light flickers on and off.	1. Photo sensor is picking up extraneous light.	1. Remove batteries to reset photo sensor settings.
Fixture stays on all night.	1. Heat source/reflective body in detection area.	1. Remove heat source/reflective body from detection zone or move fixture.
Motion sensor activates at random or for no reason.	1. Momentary heat source or reflective body.	1. Turn sensor detection field away from source.
	2. Minor sensor problem.	2. Remove batteries to reset sensor.
Motion sensor does not activate at all.	1. Batteries are depleted.	1. Check or replace batteries.
	2. ON/OFF switch is set to OFF.	2. Slide switch to ON position.
Detection range varies from day to day.	1. Changes in meteorological conditions.	1. Adjust the position of the sensor.

Need Help?

If you have questions regarding installation info@luxformglobal.com

Technical specifications and guiding lines per model.

- Take notice of all technical specifications for your product at all times.
- Below is an explanation of the pictorial signs.

